

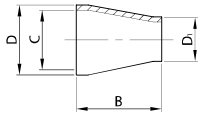

RIDUZIONE CONC. SR.  
WG. CONC. REDUCER  
RÉDUCTION CONC. SR.  
REDUCCIÓN CONC. SR.

169 L



DN	B	C	D	D <sub>1</sub>	gr
38/25	67,0	35,1	38,1	25,4	80
51/25	67,0	47,8	50,8	25,4	100
51/38	67,0	47,8	50,8	38,1	100
63/38	67,0	60,2	63,5	38,1	140
63/51	67,0	60,2	63,5	50,8	160
76/38	67,0	72,9	76,2	38,1	160
76/51	67,0	72,9	76,2	50,8	180
76/63	67,0	72,9	76,2	63,5	220
101/51	107,0	97,6	101,6	50,8	310
101/63	82,0	97,6	101,6	63,5	300
101/76	67,0	97,6	101,6	76,2	280
104/51	109,0	100,0	104,0	50,8	310
104/63	89,0	100,0	104,0	63,5	300
104/76	67,0	100,0	104,0	76,2	280

RIDUZIONE ECC. SR.  
WG. ECC. REDUCER  
RÉDUCTION EXC. SR.  
REDUCCIÓN EXC. SR.

179 L

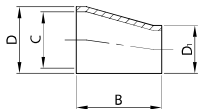

DN	B	C	D	D <sub>1</sub>	gr
38/25	67,0	35,1	38,1	25,4	80
51/25	73,0	47,8	50,8	25,4	100
51/38	67,0	47,8	50,8	38,1	100
63/38	71,0	60,2	63,5	38,1	140
63/51	67,0	60,2	63,5	50,8	160
76/38	80,0	72,9	76,2	38,1	160
76/51	67,0	72,9	76,2	50,8	180
76/63	67,0	72,9	76,2	63,5	220
101/51	110,0	97,6	101,6	50,8	310
101/63	88,0	97,6	101,6	63,5	300
101/76	67,0	97,6	101,6	76,2	280
104/51	115,0	100,0	104,0	50,8	310
104/63	88,0	100,0	104,0	63,5	300
104/76	67,0	100,0	104,0	76,2	280

RIDUZIONE CONC. EL.  
CONC. REDUCER PE.  
RÉDUCTION CONC. BL.  
REDUCCIÓN CONC. EL.

170 L

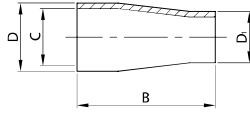

DN	B	C	D	D <sub>1</sub>	gr
38/25	97,0	35,1	38,1	25,4	110
51/25	115,0	47,8	50,8	25,4	170
51/38	97,0	47,8	50,8	38,1	150
63/38	115,0	60,2	63,5	38,1	230
63/51	97,0	60,2	63,5	50,8	190
76/38	132,0	72,9	76,2	38,1	300
76/51	115,0	72,9	76,2	50,8	260
76/63	97,0	72,9	76,2	63,5	240
101/51	145,0	97,6	101,6	50,8	590
101/63	120,0	97,6	101,6	63,5	580
101/76	120,0	97,6	101,6	76,2	580
104/51	155,0	100,0	104,0	50,8	600
104/63	140,0	100,0	104,0	63,5	590
104/76	127,0	100,0	104,0	76,2	580

RIDUZIONE ECC. EL.  
ECC. REDUCER PE.  
RÉDUCTION EXC. BL.  
REDUCCIÓN EXC. EL.

180 L

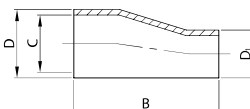

DN	B	C	D	D <sub>1</sub>	gr
38/25	104,0	35,1	38,1	25,4	125
51/25	120,0	47,8	50,8	25,4	170
51/38	105,0	47,8	50,8	38,1	160
63/38	130,0	60,2	63,5	38,1	200
63/51	103,0	60,2	63,5	50,8	220
76/38	139,0	72,9	76,2	38,1	300
76/51	126,0	72,9	76,2	50,8	280
76/63	105,0	72,9	76,2	63,5	250
101/51	150,0	97,6	101,6	50,8	590
101/63	143,0	97,6	101,6	63,5	670
101/76	128,0	97,6	101,6	76,2	630
104/51	148,0	100,0	104,0	50,8	600
104/63	145,0	100,0	104,0	63,5	590
104/76	128,0	100,0	104,0	76,2	630

RID. CONC. BF./BF. MT.  
CONC. RED. MP./MP. ED.  
RÉD. CONC. PF./PF. DN.  
RED. CONC. M./M. MD.

171 I

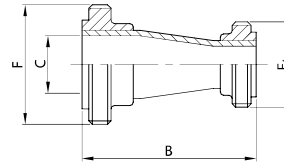

DN	B	C	F	F <sub>1</sub>	gr
38/25	97,0	35,1	50-8	37-8	260
51/25	115,0	47,8	64-8	37-8	340
51/38	97,0	47,8	64-8	50-8	370
63/38	115,0	60,5	77-8	50-8	525
63/51	97,0	60,5	77-8	64-8	505
76/38	132,0	72,9	91-8	50-8	660
76/51	115,0	72,9	91-8	64-8	640
76/63	97,0	72,9	91-8	77-8	695
101/63	120,0	97,6	118-8	77-8	1.305
101/76	120,0	97,6	118-8	91-8	1.360

RID. ECC. BF./BF. MT.  
ECC. RED. MP./MP. ED.  
RÉD. EXC. PF./PF. DN.  
RED. EXC. M./M. MD.

181 I

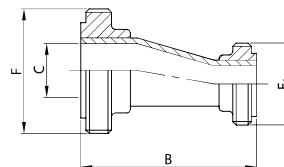

DN	B	C	F	F <sub>1</sub>	gr
38/25	104,0	35,1	50-8	37-8	275
51/25	126,0	47,8	64-8	37-8	340
51/38	105,0	47,8	64-8	50-8	380
63/38	130,0	60,5	77-8	50-8	495
63/51	103,0	60,5	77-8	64-8	535
76/38	148,0	72,9	91-8	50-8	680
76/51	126,0	72,9	91-8	64-8	660
76/63	105,0	72,9	91-8	77-8	705
101/63	143,0	97,6	118-8	77-8	1.385
101/76	128,0	97,6	118-8	91-8	1.410

RID. CONC. BL.G./BL.G. MT.  
CONC. RED. L.N./L.N. ED.  
RÉD. CONC. PLE./PLE. DN.  
RED. CONC. C.T./C.T. MD.

172 I

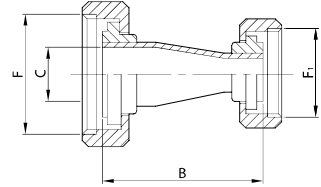

DN	B	C	F	F <sub>1</sub>	gr
38/25	97,0	35,1	50-8	37-8	650
51/25	115,0	47,8	64-8	37-8	875
51/38	97,0	47,8	64-8	50-8	965
63/38	115,0	60,5	77-8	50-8	1.295
63/51	97,0	60,5	77-8	64-8	1.420
76/38	132,0	72,9	91-8	50-8	1.515
76/51	115,0	72,9	91-8	64-8	1.640
76/63	97,0	72,9	91-8	77-8	1.870
101/63	120,0	97,6	118-8	77-8	2.800
101/76	120,0	97,6	118-8	91-8	2.940

RID. ECC. BL.G./BL.G. MT.  
ECC. RED. L.N./L.N. ED.  
RÉD. EXC. PLE./PLE. DN.  
RED. EXC. C.T./C.T. MD.

182 I

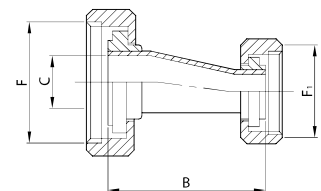

DN	B	C	F	F <sub>1</sub>	gr
38/25	104,0	35,1	50-8	37-8	665
51/25	126,0	47,8	64-8	37-8	875
51/38	105,0	47,8	64-8	50-8	975
63/38	130,0	60,5	77-8	50-8	1.265
63/51	103,0	60,5	77-8	64-8	1.450
76/38	148,0	72,9	91-8	50-8	1.535
76/51	126,0	72,9	91-8	64-8	1.660
76/63	105,0	72,9	91-8	77-8	1.880
101/63	143,0	97,6	118-8	77-8	2.880
101/76	128,0	97,6	118-8	91-8	2.990